

SV/FILTER/EC SV/HEPA/EC

HIGH EFFICIENCY AIR FILTRATION UNITS

- E.C. TECHNOLOGY MOTOR WITH BUILT-IN ELECTRONICS
- FILTERS WITH ANTI BY-PASS SETTING
- LOW NOISE LEVEL
- PRESSURE CONNECTIONS FOR FILTER CONTROL
- DIFFERENT FILTRATION STAGES DEPENDING ON THE MODEL:
 - FILTERS F6 + F8 AND F7 + F9
 - FILTER HEPA H14
 - ACTIVE CARBON FILTER
- IDEAL FOR OFFICES AND BUSINESSES
- EASY ACCESS FOR MAINTENANCE



FILTRATION
STAGES

F6 + F8

F7 + HEPA
H14

F7 + F9

G4 + FCA

SV/FILTER/EC SV/HEPA/EC

SV/FILTER/EC and SV/HEPA/EC air filtration units have been especially designed for moving and filtering air, **in installations with stringent energy efficiency, filtration, soundproofing and versatility requirements.**



INSTALLATION IN ANY POSITION



This unit is ready to be installed in any position and thanks to its low profile, it is ideal to be installed inside technical ceilings or locations with limited available space.

EASY INSTALLATION AND MAINTENANCE



An inspection cover with manual locks is used for quick access for cleaning the impeller and replacing the filters.

LOW NOISE LEVEL



The 25 mm thick acoustic casing, which reduces noise through the use of high-quality insulation materials designed for these applications, makes it the perfect fan for installation in applications that require low noise levels.



ENERGY SAVINGS

The high performance E.C. Technology electric motor is a key element in reducing electricity consumption, in addition to being easy to regulate with any 0-10 V sensor.



F

FILTRATION STAGES

4 standard filtration stage configurations are available:

F6 + F8, F7 + F9, F7 + H14, G4 + CA.

The unit is equipped with a rail for installing a 25 mm pre-filter that will extend the service life of the high efficiency filters.



CONTROL OF FILTERS

The status of both filters can be individually controlled via the three pressure connections. This control prevents over-saturating each one of the two filtering stages, in a manner that reduces the electrical consumption, allows carrying out preventive maintenance and maintains the filtration efficiency.



ANTI BY-PASS SYSTEM

The higher efficiency filter fastening system guarantees a fully airtight connection between the filter and the frame.



SV/FILTER/EC SV/HEPA/EC

DESIGNED FOR INSTALLATIONS WITH
STRINGENT **ENERGY EFFICIENCY,**
FILTRATION, SOUNDPROOFING AND
VERSATILITY REQUIREMENTS



BARS AND RESTAURANTS



SHOPPING CENTRES



MUSEUMS



GYMS



FOOD PRODUCTION UNITS
AND RIPENING ROOMS



LARGE OFFICES, CONFERENCE ROOMS
AND WAITING ROOMS



ROOMS, TOILETS AND DRESSING ROOMS



HEALTH CENTRES



SCHOOLS



PUBLIC TRANSPORTATION



LIFTS

SV/FILTER/EC

Filtration units for circular ducts and EC Technology motor



DIFFERENT FILTRATION STAGES DEPENDING ON MODEL:

- F6 + F8
- F7 + F9
- G4 + FCA



Filtration units for circular ducts, with low noise level, different filtration stage options and EC Technology motor.

Fan:

- Acoustic casing covered with sound absorbing material.
- Standardised inlet and outlet flanges with watertight joints.
- F6 + F8, F7 + F9 and G4 + CA, filters according to model.
- Easy access inspection and cleaning cover with manual fasteners.
- Centrifugal fan with a backward curved impeller.
- Integrated support into the box which facilitates its assembly.
- Linear airflow direction.
- 3 pressure taps for individual control of the two filtration stages.

- Installation in any position.
- With guide slot for 25 mm prefilter.
- More efficient filter anti-by-pass adjustment.

Motor:

- High efficiency external rotor EC Technology motors, adjustable via 0-10 V signal.
- Single-phase 220-240 V 50/60 Hz, IP54 protection.
- Maximum temperature of air to be carried: -25 °C +60 °C.

Finish:

- Anti-corrosive in galvanized steel sheet.

Order code

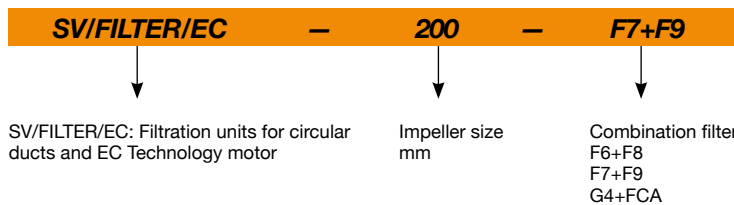

Technical characteristics

Model	Speed (r/min)	Maximum admissible current (A)		Maximum power (W)	Maximum flow rate (m³/h)			Sound pressure level at 50% of max. speed* dB (A)	Approx. weight (Kg)	According ErP
		230V			F6+F8	F7+F9	G4+CA			
SV/FILTER/EC-150	3540	0.97		120	553	527	454	38	14	2018
SV/FILTER/EC-200	3265	1.35		176	768	734	641	45	17	2018
SV/FILTER/EC-250	2850	1.35		180	913	850	744	49	19	2018
SV/FILTER/EC-315	2320	2.00		450	1917	1806	1507	52	34	2018
SV/FILTER/EC-350	1460	1.45		190	1532	1382	1061	42	39	2018
SV/FILTER/EC-400	1700	4.70		750	3279	3024	2428	52	66	2018

* Irradiated sound pressure level in dB(A) at a distance of 1 m.



Erp. (Energy Related Products)

Information on Directive 2009/125/EC can be downloaded from the SODECA website or the QuickFan selector programme.

Acoustic characteristics

Sound power spectrum Lw(A) in dB(A) per Hz frequency band
Irradiated values at maximum speed and medium flow rate.

	63	125	250	500	1000	2000	4000	8000
SV/FILTER/EC-150	56	52	56	54	48	43	39	33
SV/FILTER/EC-200	63	59	63	61	55	50	46	40
SV/FILTER/EC-250	67	63	67	65	59	54	50	44
SV/FILTER/EC-315	69	66	70	67	61	57	53	47
SV/FILTER/EC-350	59	56	60	58	53	50	47	41
SV/FILTER/EC-400	70	66	70	68	62	57	53	47

Dimensions mm

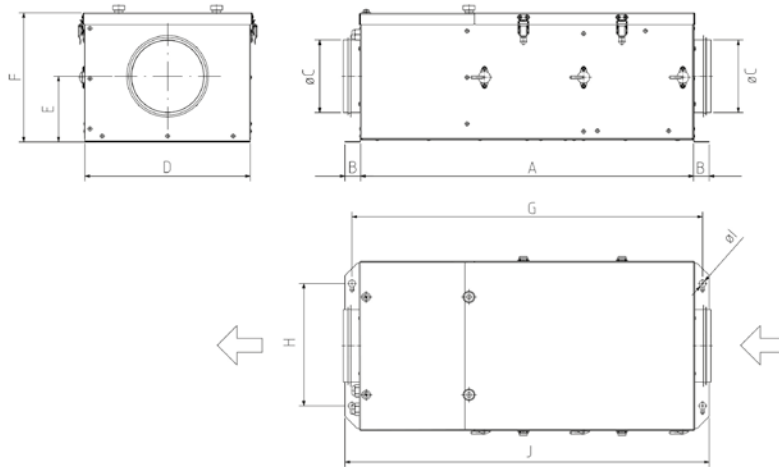

	A	B	ØC	D	E	F	G	H	ØI	J
SV/FILTER/EC-150	680	34.5	150	340	134.5	262.5	715	250	14	750
SV/FILTER/EC-200	700	38.5	200	395	152	300	735	290	14	780
SV/FILTER/EC-250	750	48.5	250	420	162	323	785	335	14	850
SV/FILTER/EC-315	830	58	310	520	202	404	865	435	14	950
SV/FILTER/EC-350	920	56	350	610	223.5	446	955	525	14	1030
SV/FILTER/EC-400	1000	60.5	400	670	251.5	505.5	1030	575	14	1120

Accessories



Characteristic curves

Q= Flow rate in m³/h, m³/s and cfm

Pe= Static pressure in mm H₂O, Pa and inwg

SV/FILTER/EC 150

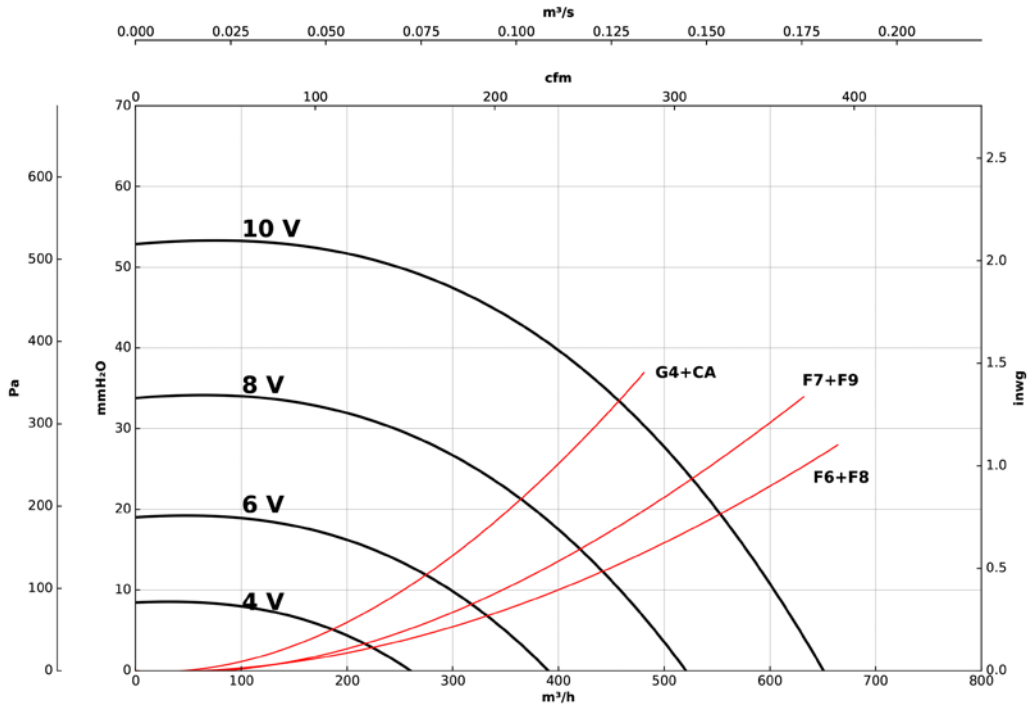

SV/FILTER/EC 200

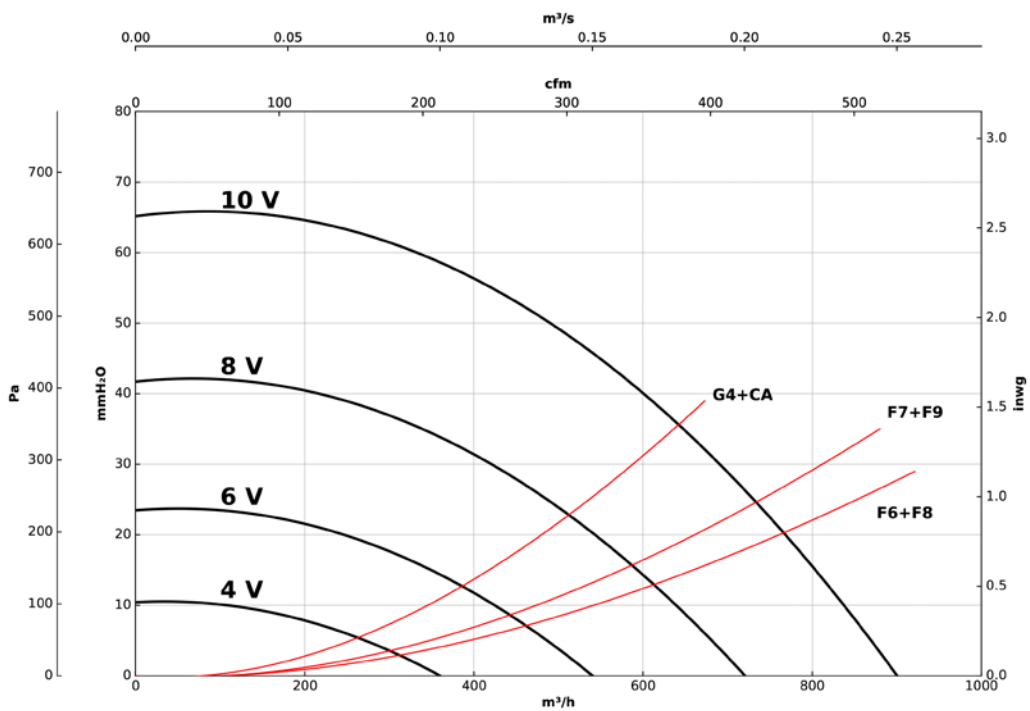

Characteristic curves

Q= Flow rate in m³/h, m³/s and cfm

Pe= Static pressure in mm H₂O, Pa and inwg

SV/FILTER/EC 250

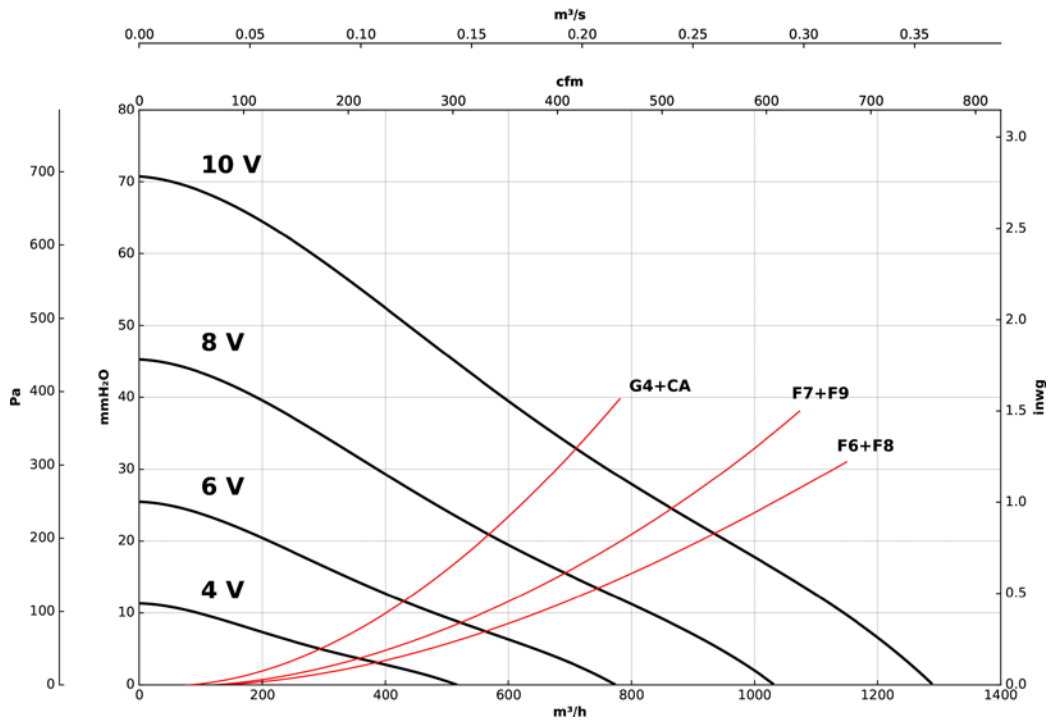

SV/FILTER/EC 315

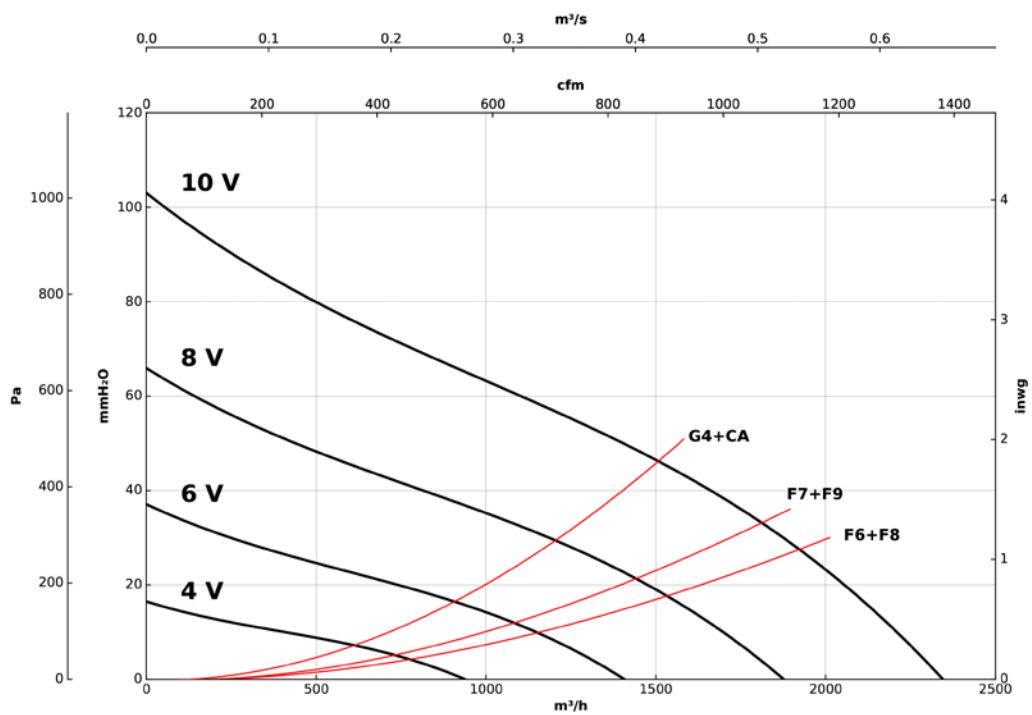

Characteristic curves

Q= Flow rate in m³/h, m³/s and cfm

Pe= Static pressure in mm H₂O, Pa and inwg

SV/FILTER/EC 350

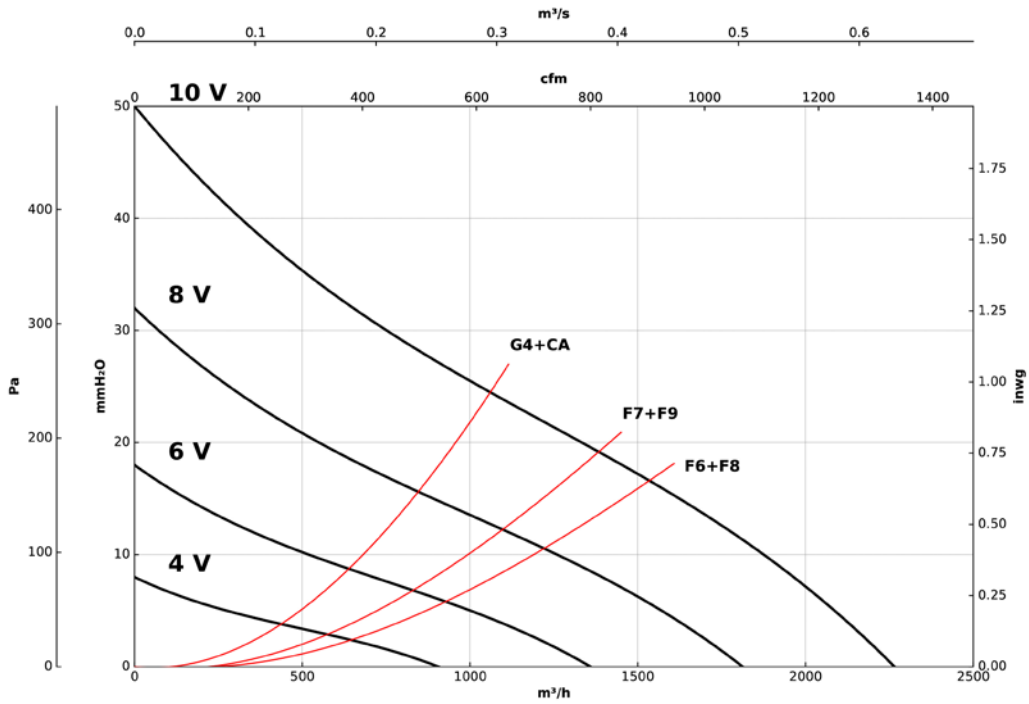

SV/FILTER/EC 400

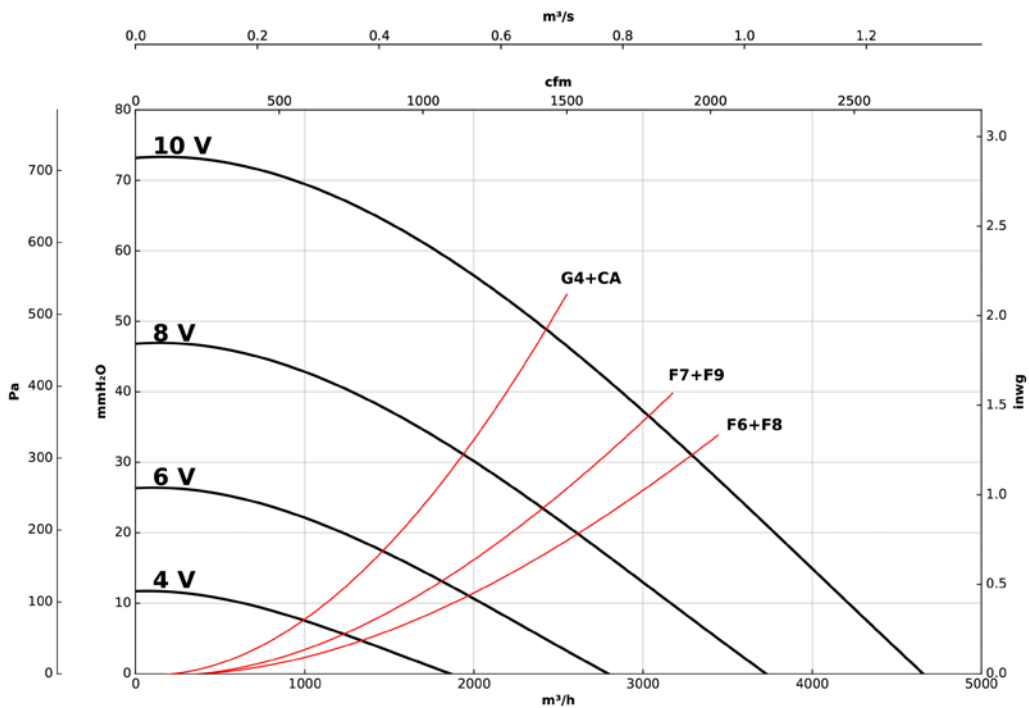

SV/HEPA/EC

HEPA filtration units for circular ducts and EC Technology motor



HEPA filtration units for circular ducts, with low noise level and EC Technology motor.

Fan:

- Acoustic casing covered with sound absorbing material.
- Standardised inlet and outlet flanges with watertight joints.
- F7 + H14 filters.
- Easy access inspection and cleaning cover with manual fasteners.
- Centrifugal fan with a backward curved impeller.
- Integrated support into the box which facilitates its assembly.
- Linear airflow direction.
- 3 pressure taps for individual control of the two filtration stages.

- Installation in any position.
- With guide slot for 25 mm prefilter.
- More efficient filter anti-by-pass adjustment.

Motor:

- High efficiency external rotor EC Technology motors, adjustable via 0-10 V signal.
- Single-phase 220-240 V 50/60 Hz, IP54 protection.
- Maximum temperature of air to be carried: -25 °C +60 °C.

Finish:

- Anti-corrosive in galvanized steel sheet.

Order code

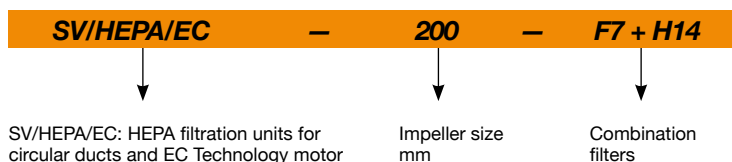

Technical characteristics

Model	Speed (r/min)	Maximum admissible current (A)	Maximum power	Maximum flow rate	Sound pressure level at 50% of max. speed*	Approx. weight (Kg)	According ErP
		230V	(W)	(m ³ /h)	dB (A)		
SV/HEPA/EC-150	3540	0.97	120	375	38	14	2018
SV/HEPA/EC-200	3265	1.35	176	544	45	17	2018
SV/HEPA/EC-250	2850	1.35	180	582	49	19	2018
SV/HEPA/EC-315	2320	2.00	450	1223	52	34	2018
SV/HEPA/EC-350	1460	1.45	190	827	42	39	2018
SV/HEPA/EC-400	1700	4.70	750	1918	52	66	2018

* Irradiated sound pressure level in dB(A) at a distance of 1 m.



Erp. (Energy Related Products)

Information on Directive 2009/125/EC can be downloaded from the SODECA website or the QuickFan selector programme.

Acoustic characteristics

Sound power spectrum Lw(A) in dB(A) per Hz frequency band
Irradiated values at maximum speed and medium flow rate.

	63	125	250	500	1000	2000	4000	8000
SV/HEPA/EC-150	56	52	56	54	48	43	39	33
SV/HEPA/EC-200	63	59	63	61	55	50	46	40
SV/HEPA/EC-250	67	63	67	65	59	54	50	44
SV/HEPA/EC-315	69	66	70	67	61	57	53	47
SV/HEPA/EC-350	59	56	60	58	53	50	47	41
SV/HEPA/EC-400	70	66	70	68	62	57	53	47

Dimensions mm

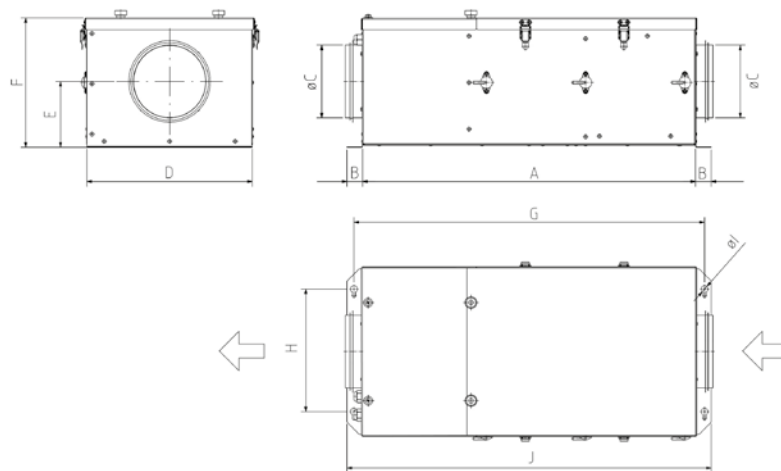

	A	B	ØC	D	E	F	G	H	ØI	J
SV/HEPA/EC-150	680	34.5	150	340	134.5	262.5	715	250	14	750
SV/HEPA/EC-200	700	38.5	200	395	152	300	735	290	14	780
SV/HEPA/EC-250	750	48.5	250	420	162	323	785	335	14	850
SV/HEPA/EC-315	830	58	310	520	202	404	865	435	14	950
SV/HEPA/EC-350	920	56	350	610	223.5	446	955	525	14	1030
SV/HEPA/EC-400	1000	60.5	400	670	251.5	505.5	1030	575	14	1120

Accessories



Characteristic curves

Q= Flow rate in m³/h, m³/s and cfm

Pe= Static pressure in mm H₂O, Pa and inwg

SV/HEPA/EC 150

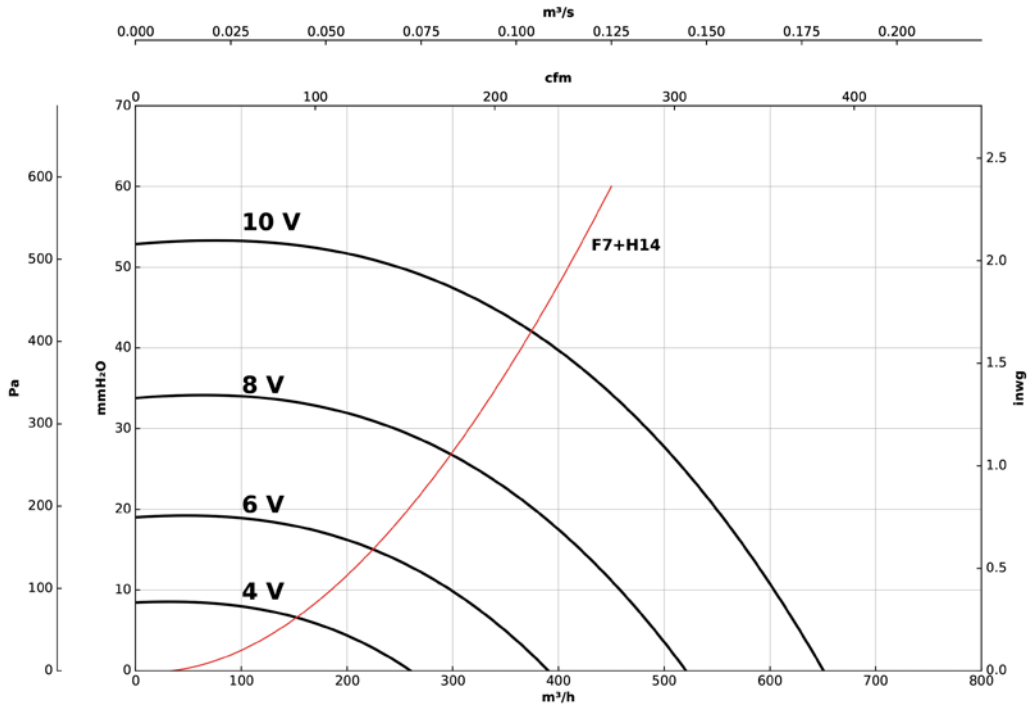

SV/HEPA/EC 200

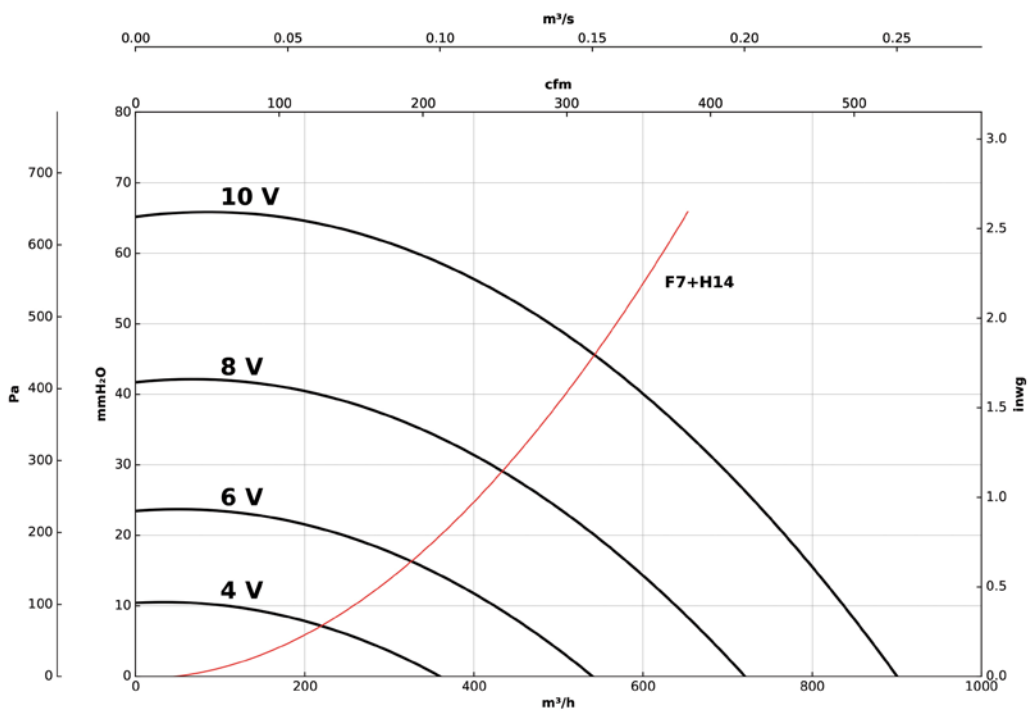

Characteristic curves

Q= Flow rate in m³/h, m³/s and cfm

Pe= Static pressure in mm H₂O, Pa and inwg

SV/HEPA/EC 250

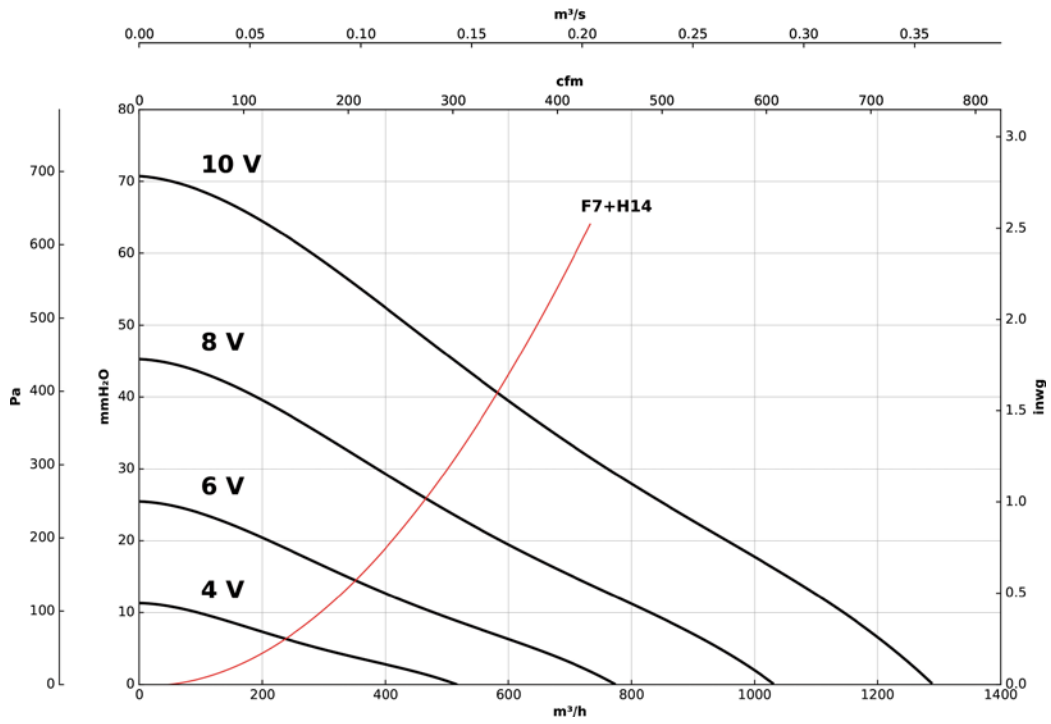

SV/HEPA/EC 315

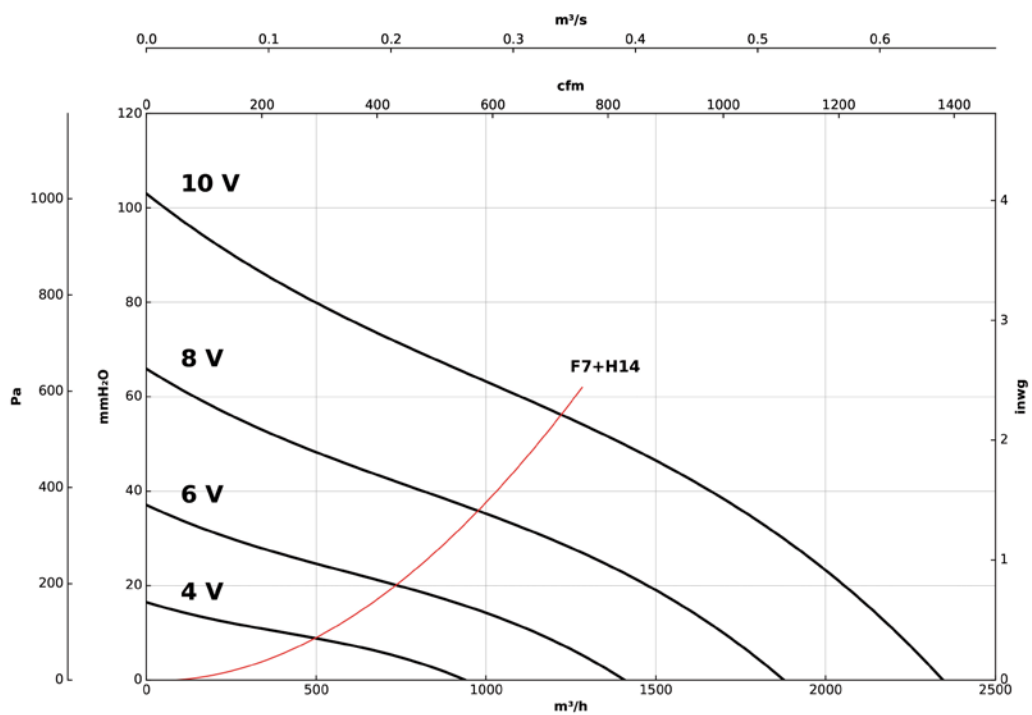

Characteristic curves

Q= Flow rate in m³/h, m³/s and cfm

Pe= Static pressure in mm H₂O, Pa and inwg

SV/HEPA/EC 350

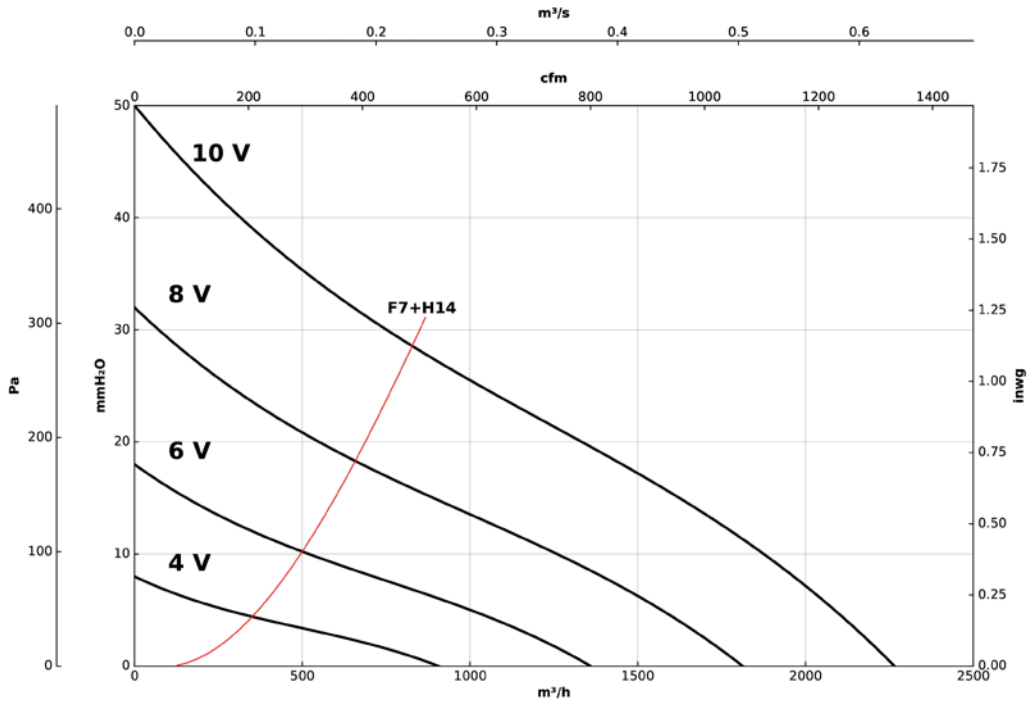

SV/HEPA/EC 400

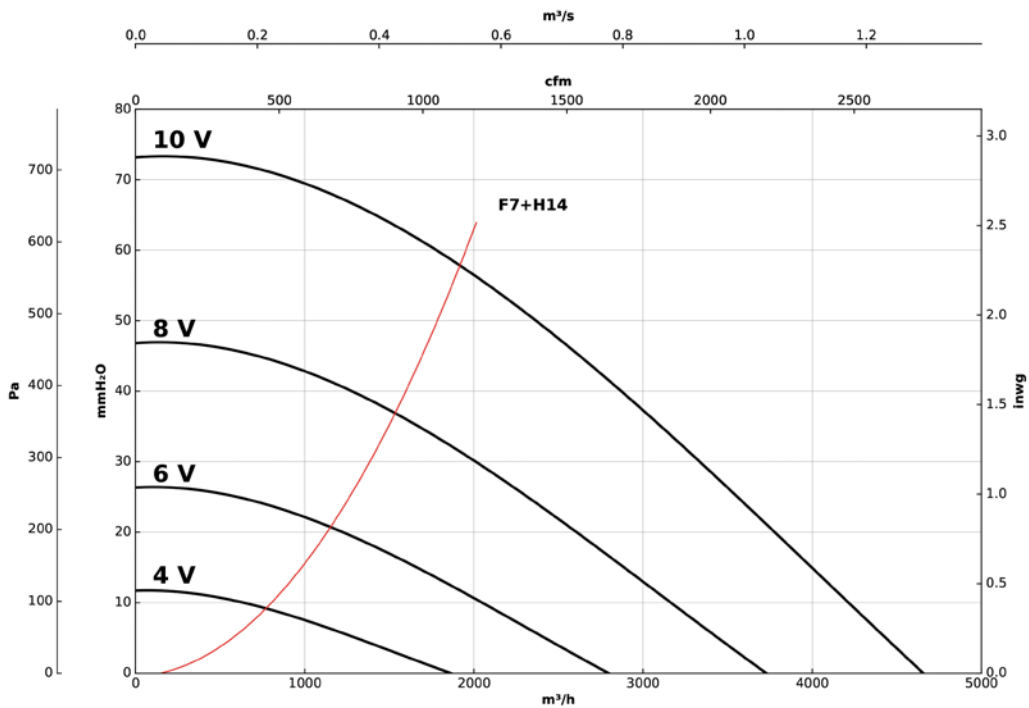



HEADQUARTER

Sodeca, S.L.U.

Pol. Ind. La Barricona
Carrer del Metall, 2
E-17500 Ripoll
Girona, SPAIN
Tel. +34 93 852 91 11
Fax: +34 93 852 90 42
General sales: comercial@sodeca.com
Export sales: ventilation@sodeca.com

PRODUCTION PLANT

Sodeca, S.L.U.

Ctra. de Berga, km 0,7
E-08580 Sant Quirze de Besora
Barcelona, SPAIN
Tel. +34 93 852 91 11
Fax: +34 93 852 90 42
General sales: comercial@sodeca.com
Export sales: ventilation@sodeca.com



EUROPE

FINLAND

Sodeca Finland, Oy

HUITTINEN
Sales and Warehouse
Mr. Kai Yli-Sipilä
Metsälännankatu 26
FI-32700 Huitinen
Tel. + 358 400 320 125
orders.finland@sodeca.com

HELSINKI
Smoke Control Solutions
Mr. Antti Kontkanen
Vilppulantie 9C
FI-00700 Helsinki
Tel. +358 400 237 434
akontkanen@sodeca.com

HYVINKÄÄ
Industrial Applications
Mr. Jaakko Tomperi
Niinistökatu 12
FI-05800 Hyvinkää
Tel. +358 451 651 333
jtomperi@sodeca.com

ITALIA

Marelli Ventilazione, S.R.L.

Viale del Lavoro, 28
37036 San Martino B.A.
(VR), ITALY
Tel. +39 045 87 80 140
vendite@sodeca.com

PORTUGAL

Sodeca Portugal, Unip. Lda.

PORTO
Rua Veloso Salgado
1120/1138
4450-801 Leça de Palmeira
Tel. +351 229 991 100
geral@sodeca.pt

LISBOA
Pq. Emp. da Granja Pav. 29
2625-607 Vialonga
Tel. +351 219 748 491
geral@sodeca.pt

ALGARVE
Rua da Alegria, 33
8200-569 Ferreiras
Tel. +351 289 092 586
geral@sodeca.pt

UNITED KINGDOM

Sodeca Fans UK, Ltd.

Mr. Mark Newcombe
Tamworth Enterprise Centre
Philip Dix House, Corporation
Street, Tamworth, B79 7DN
UNITED KINGDOM
Tel. +44 (0) 1827 216 109
sales@sodeca.co.uk

AMERICA

CHILE

Sodeca Ventiladores, SpA.

Sra. Sofía Ormazábal
Santa Bernardita 12.005
(Esquina con Puerta Sur)
Bodegas 24 a 26,
San Bernardo, Santiago,
CHILE
Tel. +56 22 840 5582
ventas.chile@sodeca.com

COLOMBIA

Sodeca Latam, S.A.S.

Sra. Luisa Stella Prieto
Calle7 No. 13 A-44
Manzana 4 Lote1, Montana
Mosquera, Cundinamarca
Bogotá, COLOMBIA
Tel. +57 1 756 4213
ventascolombia@sodeca.co

PERU

Sodeca Perú, S.A.C.

Sr. Jose Luis Jiménez
C/ Mariscal Jose Luis de
Orbegoso 331. Urb. El pino.
15022, San Luis. Lima, PERÚ
Tel. +51 1 326 24 24
Cel. +51 994671594
comercial@sodeca.pe

RUSSIA

RUSSIA

Sodeca, L.L.C.

Mr. Stanislav Alifanov
Severnoye Shosse, 10 room 201
Business Park Plaza Ramstars
140105 Ramenskoye,
Moscow region, RUSSIA
Tel. +7 495 955 90 50
alifanov@sodeca.com



www.sodeca.com

